

# AXONOMETRIE - ROZMÍSTĚNÍ PŘEKÁŽEK

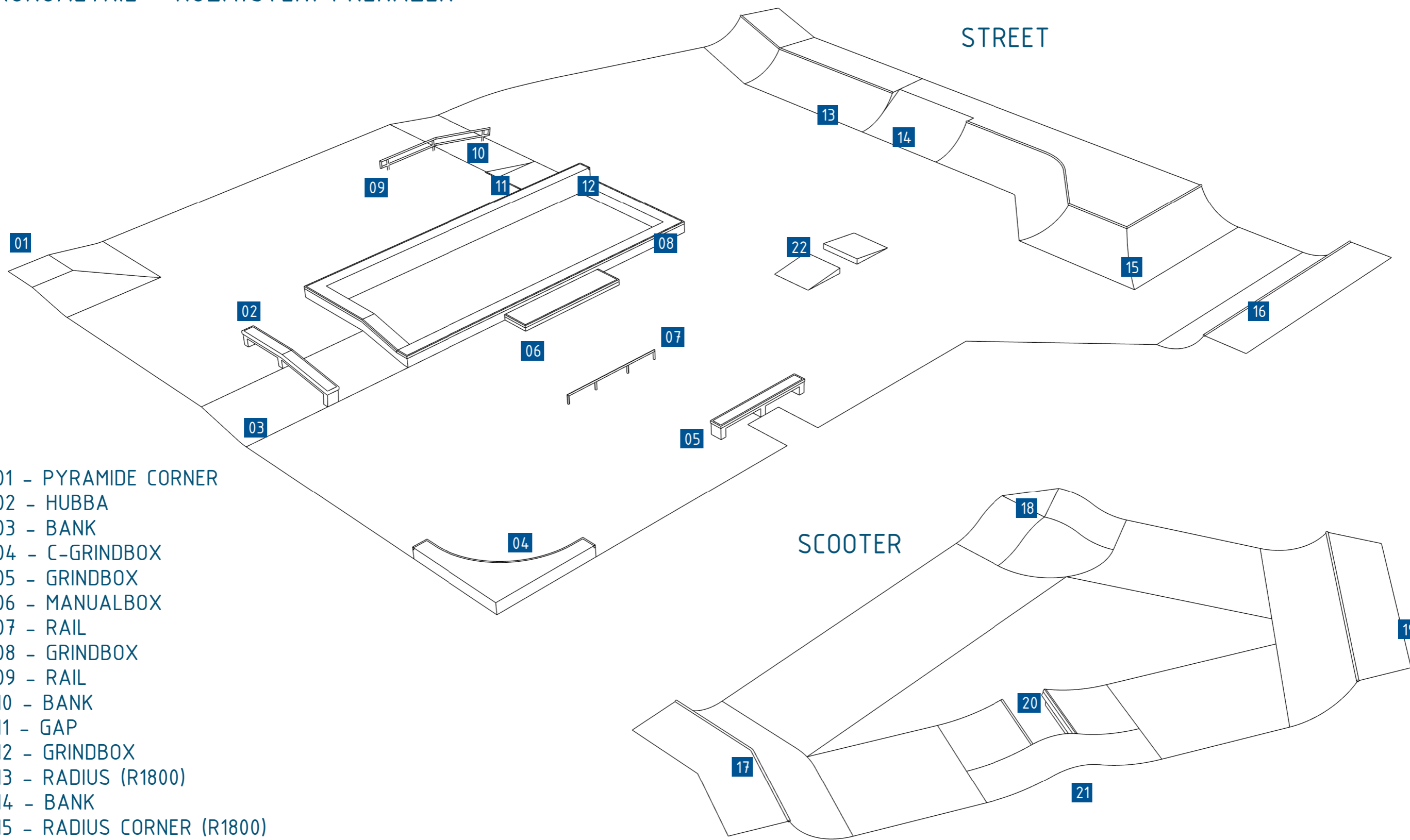

- 01 - PYRAMIDE CORNER
- 02 - HUBBA
- 03 - BANK
- 04 - C-GRINDBOX
- 05 - GRINDBOX
- 06 - MANUALBOX
- 07 - RAIL
- 08 - GRINDBOX
- 09 - RAIL
- 10 - BANK
- 11 - GAP
- 12 - GRINDBOX
- 13 - RADIUS (R1800)
- 14 - BANK
- 15 - RADIUS CORNER (R1800)
- 16 - MINIRAMP (R1800)
- 17 - RADIUS CORNER
- 18 - CAMELHUMP
- 19 - RADIUS (R1800)
- 20 - KICKER GAP
- 21 - CAMELHUMP
- 22 - KICKER GAP

HORNÍ HRANA PŘEKÁŽEK 02, 04, 05, 06, 08, 11, 12, 20, 22 JE OSAZENA UZAVŘENÝM PROFILEM 80x50x3 mm.  
 HORNÍ HRANA PŘEKÁŽEK 13, 15, 16, 17, 16 JE OSAZENA TRUBKOU Ø60 mm.  
 PŘEKÁŽKY 07 A 09 JSOU VYROBENY Z TRUBKY Ø60 mm.  
 POVRCHOVÁ ÚPRAVA VŠECH KOVOVÝCH PRVKŮ BUDE PROVEDENA ŽÁROVÝM ZINKOVÁNÍM

# ŘEZY A - C

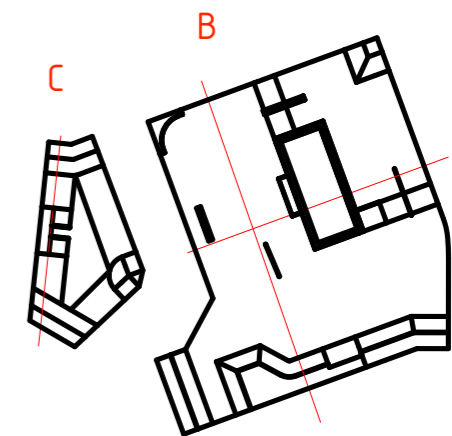

A

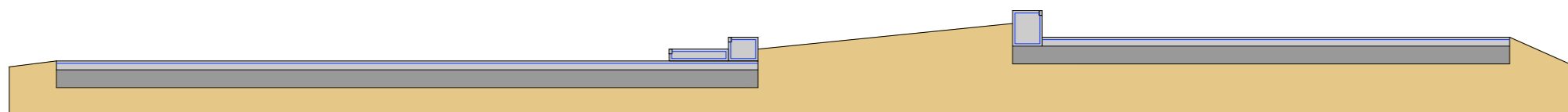

B

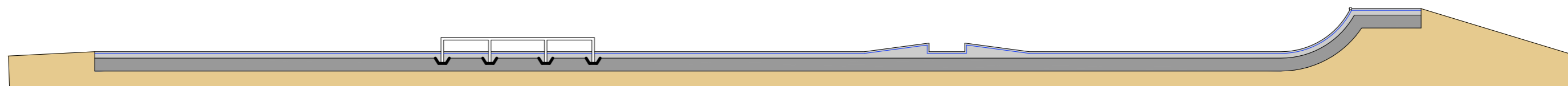



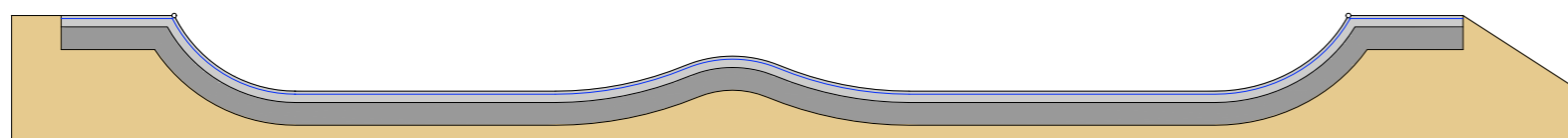

C

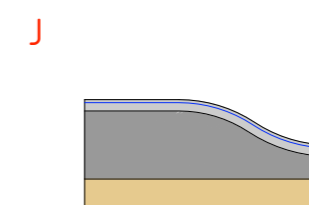
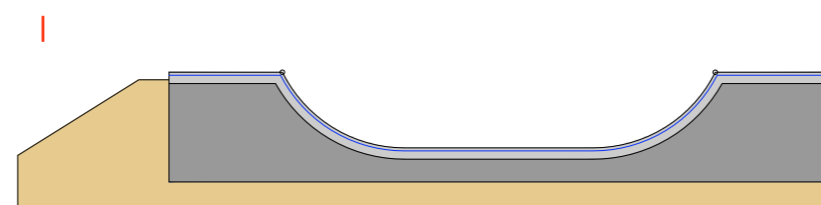
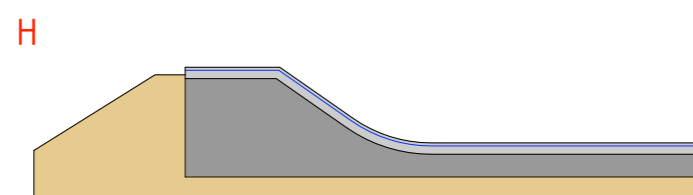
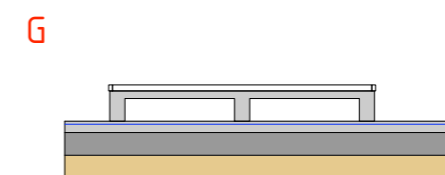
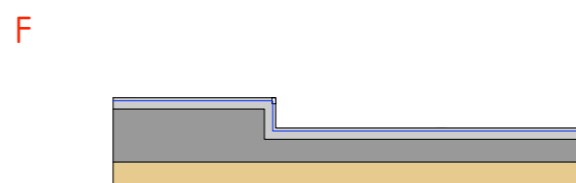
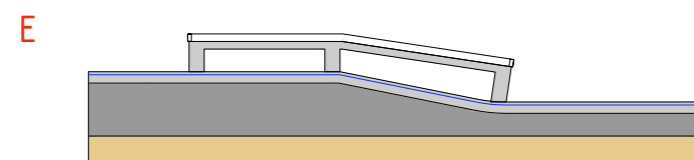
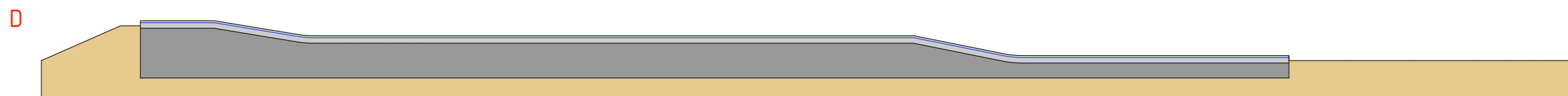
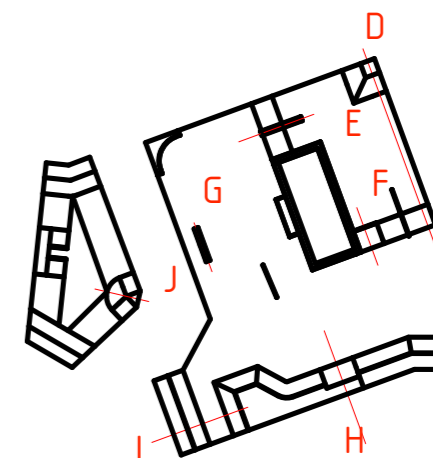

-  beton (150mm)
-  výztuž (síť kari Ø8mm, 150mm x 150mm), min. krytí 40mm
-  hutněné kamenivo fr. 0/32 resp. 0/63 (min. 300mm)
-  rostlý terén

# ŘEZY D - J



-  beton (150mm)
-  výztuž (síť kari Ø8mm, 150mm x 150mm), min. krytí 40mm
-  hutněné kamenivo fr. 0/32 resp. 0/63 (min. 300mm)
-  rostlý terén

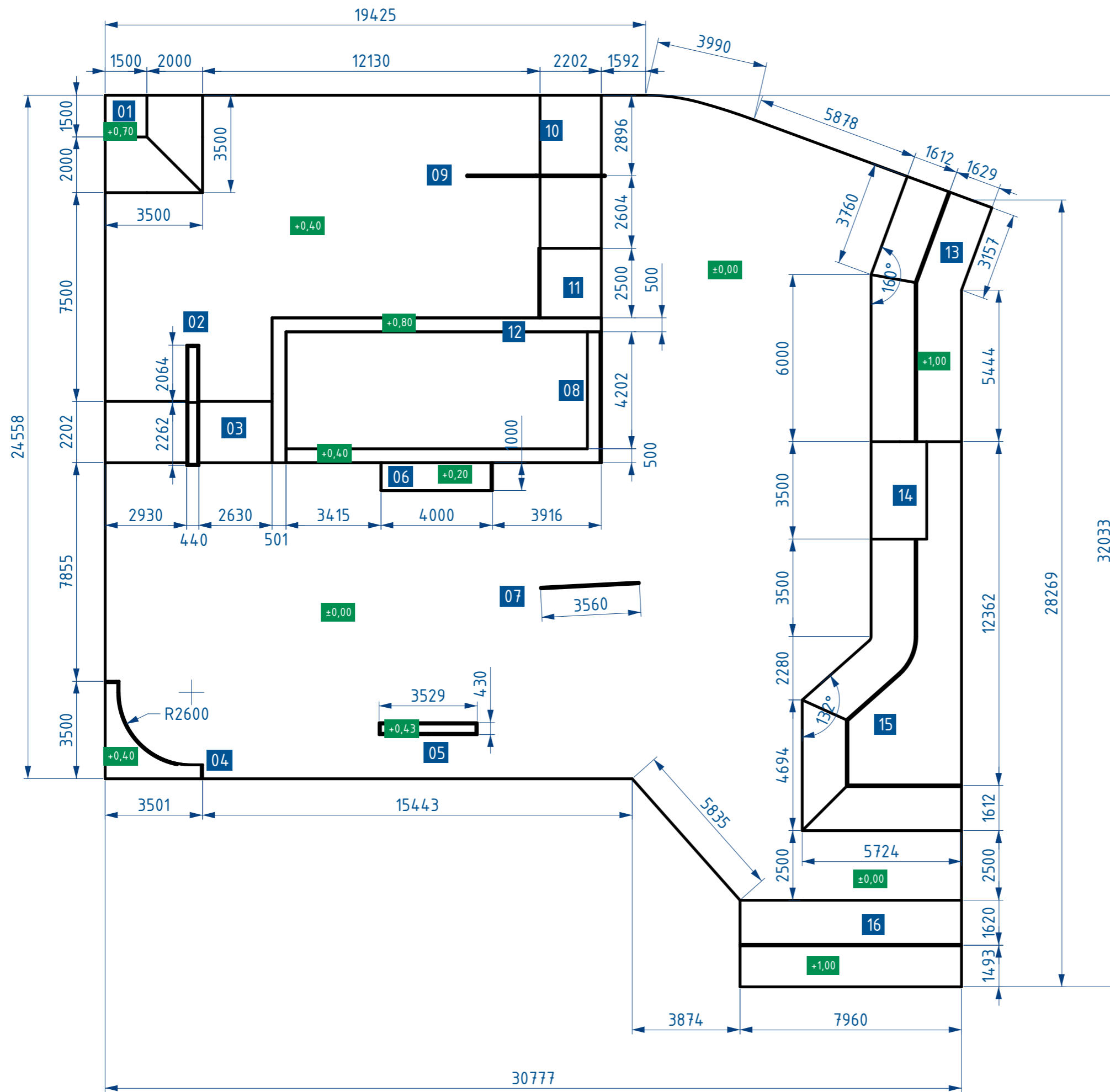

- 01 - PYRAMIDE CORNER
- 02 - HUBBA
- 03 - BANK
- 04 - C-GRINDBOX
- 05 - GRINDBOX
- 06 - MANUALBOX
- 07 - RAIL
- 08 - GRINDBOX
- 09 - RAIL
- 10 - BANK
- 11 - GAP
- 12 - GRINDBOX
- 13 - RADIUS
- 14 - BANK
- 15 - RADIUS CORNER
- 16 - MINIRAMP

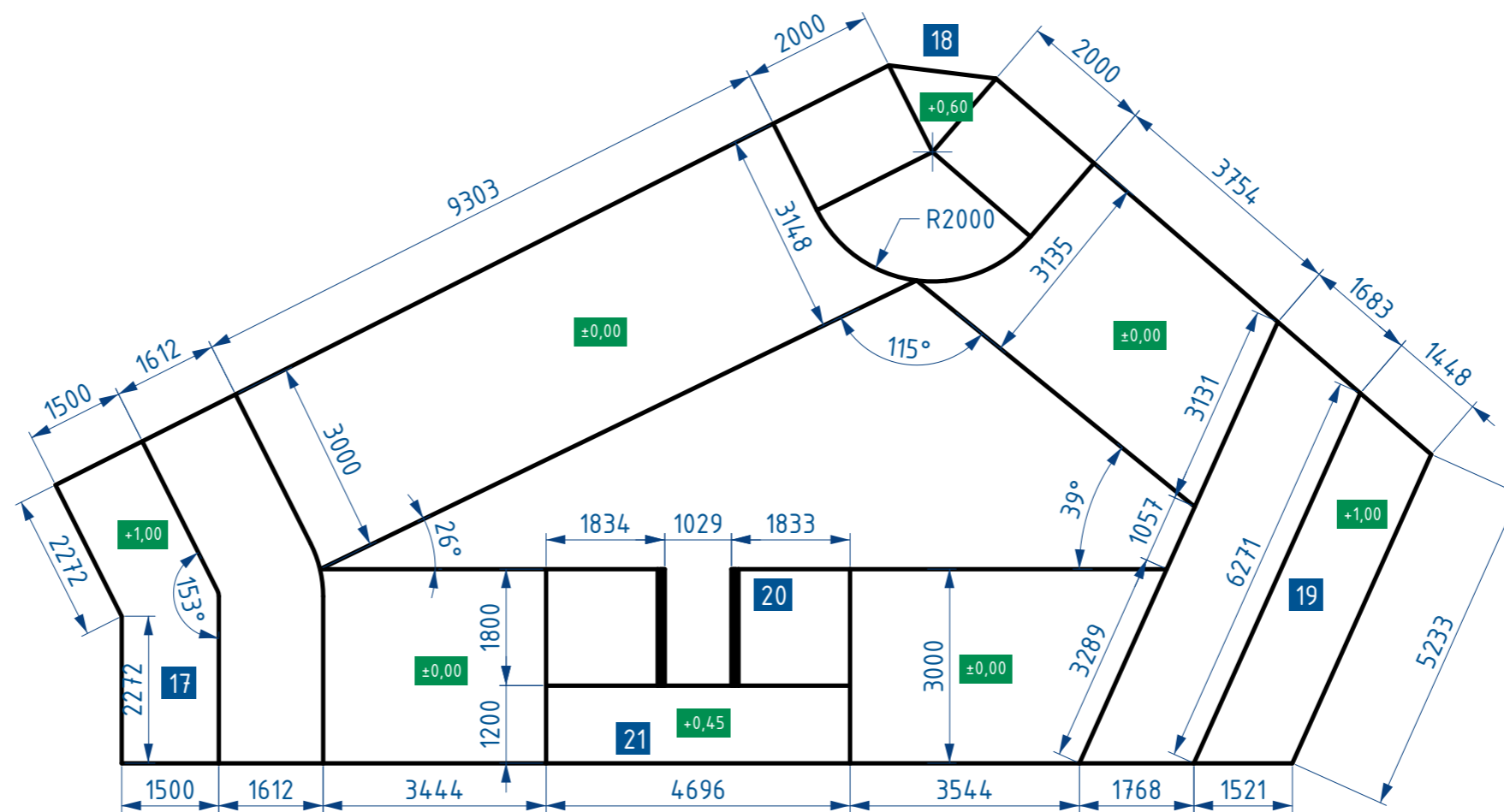

- 17 - RADIUS CORNER
- 18 - CAMELHUMP
- 19 - RADIUS
- 20 - KICKER GAP
- 21 - CAMELHUMP

## PŪDORYS SKATEPARK SCOOTER